

# Soils Map

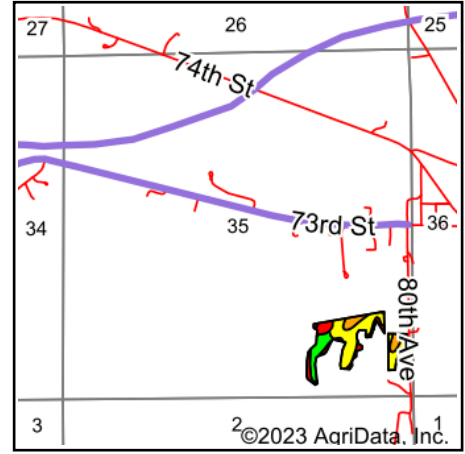

Soils data provided by USDA and NRCS.



State: **Iowa**  
 County: **Wapello**  
 Location: **35-72N-13W**  
 Township: **Agency**  
 Acres: **14.12**  
 Date: **7/6/2023**



Maps Provided By:



Area Symbol: IA179, Soil Area Version: 31

Code	Soil Description	Acres	Percent of field	CSR2 Legend	Non-Irr Class *c	CSR2**	CSR	
132C	Weller silt loam, 5 to 9 percent slopes	7.16	50.7%		IIIe	59	35	
425D	Keswick loam, 9 to 14 percent slopes	2.72	19.3%		IVe	8	10	
80C	Clinton silt loam, 5 to 9 percent slopes	2.31	16.4%		IIIe	72	65	
132B	Weller silt loam, 2 to 5 percent slopes	1.84	13.0%		IIIe	67	55	
65G	Lindley loam, 25 to 40 percent slopes	0.09	0.6%		VIIe	7	5	
<b>Weighted Average</b>						<b>3.22</b>	<b>52</b>	<b>37.5</b>

\*\*IA has updated the CSR values for each county to CSR2.

\*c: Using Capabilities Class Dominant Condition Aggregation Method

Soils data provided by USDA and NRCS.